

7500 Series

Vaportite Enclosed Strip



General Characteristics:

Lamp Type: 1, 2 or 4 Lamp T5 or T8
 Ballast Type: Electronic Ballast
 Standard Voltage: Universal 120-277
 Options: Dimming Ballast, Step Dimming Ballast, Emergency Ballast, Occupancy Sensor, Wet Occupancy Sensor, Daylight/ Occupancy Sensor, Sensor Extension Bracket, Polycarbonate Diffuser, Radial Lens, With Lamps, Tamper Proof Latches
 Additional Info: UL Certified, NSF Rated , IP 65 & IP 67 Rated, and Title 24 Compliant

| | |
|--------------------|--------------|
| Catalog No. | Type: |
| Job Name: | |

Specifications & Features:

Manufactured gasketed enclosures, which are totally dust and moisture resistant. The enclosure is constructed of a fiberglass upper body and an acrylic diffuser, crepe pattern diffuser securely positioned in a permanent poured in place sealing gasket. The diffuser and upper components are locked into place by retaining latches, assuring a secure, tight seal. Ideal for Food Processing, Kitchens, Parking Garages, Car Washes Schools, Government Facilities, Industrial Facilities, and Public Areas.

- Structurally rigid fiberglass body– fiberglass is reinforced polyester and self-extinguishing
- The gasketed inverted U-slot provides a positive continuous seal between body and diffuser
- Brass fixture Mounting stud– The fixture studs are integrally molded into the body to facilitate lighting and installation
- High Impact Acrylic Diffuser– Internal crepe pattern allows a smooth exterior surface for ease of cleaning
- Diffuser– The diffuser flange fits snugly into the gasketed retention slot forming a continuous seal
- Standard with mounting brackets

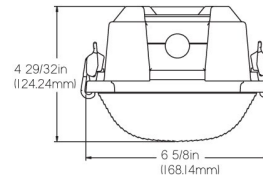

Radial Lens

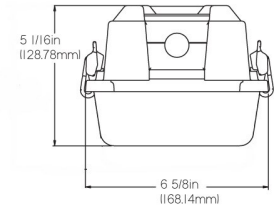

Standard

Catalog Ordering: Example: 7548-232-DIM



| FAMILY TYPE | LENGTH IN INCHES/ LAMPING | # OF BALLAST | BALLAST/ VOLTAGE | OPTIONS |
|-------------|-----------------------------|--------------|--|---|
| 75 | 24-117 (1- F17T8) | /1 | UNV (120-277 Volt) | EMR (450 Lumen Emergency Ballast) |
| | 24-217 (2- F17T8) | /2 | MVL (Instant Start Multi-Volt Low) | EMR 1400 (1400 Lumen Emergency Ballast) |
| | 48-132 (1- F32T8) | | MVN (Instant Start Multi-Volt Normal) | EX (Sensor Extension Bracket) |
| | 48-232 (2- F32T8) | | MVH (Instant Start Multi-Volt High) | OS (Occupancy Sensor) |
| | 48-332 (3- F32T8) | | MVPSL (Multi-Volt Program Start- Low) | OSD (Daylight/ Occupancy Sensor) |
| | 96-T8-EL (2- F96T8) | | MVPSN (Multi-Volt Program Start-Normal) | OSW (Occupancy Sensor– Wet) |
| | 96-132T (2- F32T8) | | MVPSH (Multi-Volt Program Start- High) | PC (Polycarbonate Diffuser) |
| | 96-232T (4- F32T8) | | IS/PS (1- Instant Start/ 1- Program Start)* | RL (Radial Lens) |
| | 96-T8-EL-HO (2- F96T8HO) | | DIM (Dimming Ballast) | WL (With Lamps) |
| | 96-T12-EL-HO (2- F96T12-HO) | | SDIM-73233 (GE 60% Step Dimming for Two T8) | TPL (Tamper Proof Latches) |
| | 24-214 (2- F14T5) | | SDIM-51496 (Osram 50% Step Dimming for 2 T5 Lamps) | |
| | 24-224 (2- F24T5HO) | | 480 (480 Volt) | |
| | 48-228 (2- F28T5) | | 480SD (480 Volt Step Down) | |
| | 48-254 (2- F54T5HO) | | | |
| | 96-228T (4- F28T5) | | | |
| | 96-254T (4- F54T5HO) | | | |

* Available with one Instant Start Ballast operating one lamp and one Program Start Ballast operating the other (Meant for a sensed fixture)